



Signage Zone

Cambridge Street

**PROMINENT FITTED RESTAURANT / LEISURE UNIT TO LET – BY WAY OF ASSIGNMENT / SUB-LEASE**

**HARROGATE – 37 Cambridge Street, HG1 1RX**

**.stärka**

**Pudney Shuttleworth**  
RETAIL & LEISURE PROPERTY CONSULTANTS  
0113 203 1130

### Location

The property is located in the centre of Harrogate, known for its historic charm and elegant architecture. It is around 35 minutes on the train to Leeds city centre and close to a variety of restaurants, such as The Ivy, Betty's, Wagamama's and Five Guys. It is amongst a prime retail area, with retailers such as Russell & Bromley, White Stuff and The White Company, as well as an Everyman Cinema.

### Address

37 Cambridge Street, Harrogate HG1 1RX

### Accommodation

The unit provides the following approximate areas-

Ground Floor Entrance :	38 sqm (409 sq ft)
First Floor Ancillary :	35.2 sqm (379 sq ft)
First Floor Sales :	533 sqm (5,735 sq ft)
Total :	606 sqm (6,523 sq ft)

There is a main trading stair and a customer lift between Ground Floor and First Floor  
Potential for an additional 785 sqm (8,447 sq ft) on the upper floors subject to discussion with landlord

### Terms

Unit to let by way of assignment or sub-lease with the head-lease expiring in June 2042. The lease is inside the Landlord and Tenant Act 1954. The passing is £150,000 pax. A sub-lease is also available on terms to be agreed.

### Premises License

There is an existing 2AM premises license that can be transferred.

### Handover specification

To be agreed between parties but substantially fitted. The Tenant will consider leaving all kitchen and M&E equipment in situ subject to negotiation.

### Service charge:

Service Charge: £6,852 per annum.

### Rates

The current Rateable Value is to be confirmed however we have been advised the estimated Rateable Value is expected to be £123,750. We recommend that parties make their own enquiries directly to the Local Rating Authority to verify the current rating liability.

### EPC

An EPC will be provided upon request.

### VAT

VAT will be charged on all rents and other outgoings quoted.



**SUBJECT TO CONTRACT**





Stärka Limited and the vendors of this property give notice that these particulars do not constitute the whole or any part of an offer or binding contract between parties. Whilst we believe that we have provided accurate information at the time of compilation, the accuracy of any statement contained within these particulars cannot be guaranteed and the onus is on prospective lessees to satisfy themselves on the correctness. All measurements are approximate areas and no responsibility is taken for any error, omission or mis-statement. Where there is reference in the particulars that alterations have been carried out or that a particular use is made of any part of the property, this is not intended to be a statement that any necessary planning, building or other consents have been obtained and these matters must be verified by prospective parties. Neither the leasing agent, nor anybody employed by Stärka Limited, has any authority to make or give any representation or warranty in relation to this particular property. Unless otherwise stated above, then all prices, rents and other outgoings will be quoted as being exclusive of VAT, which may be charged at the prevailing rate. Published May 2024.

Property Misdescription Act 1991 & Property Misrepresentation act 1967.  
 Stärka Limited, Registered in the UK with Company Registration Number: 13703266

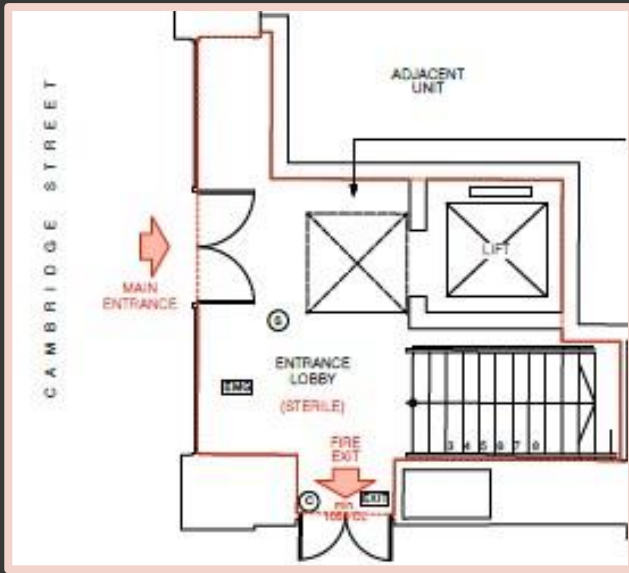

**Ground Floor Entrance**  
38 sqm (409 sq ft)



**First Floor 568 sqm (6,114 sq ft)**

**Viewings**

Interested parties are to contact the Joint Letting Agents, Stärka and Pudney Shuttleworth, to arrange a viewing on the property.

**Sammy Jones**  
Tel: 07447 048628  
[sammy@starkaproperty.com](mailto:sammy@starkaproperty.com)

**Tess Gill**  
Tel: 07788 284 982  
[tess@starkaproperty.com](mailto:tess@starkaproperty.com)

**Miriam Hughes**  
Tel: 07470 862042  
[mh@pudneyshuttleworth.co.uk](mailto:mh@pudneyshuttleworth.co.uk)

**Richard Shuttleworth**  
Tel: 07747 008458  
[rs@pudneyshuttleworth.co.uk](mailto:rs@pudneyshuttleworth.co.uk)

**Will Hepplewhite**  
Tel: 07846 006790  
[wh@pudneyshuttleworth.co.uk](mailto:wh@pudneyshuttleworth.co.uk)